

Rittal – The System.

Faster – better – everywhere.

Digital Brochure

ENCLOSURES

POWER DISTRIBUTION

CLIMATE CONTROL

IT INFRASTRUCTURE

SOFTWARE & SERVICES

FRIEDHELM LOH GROUP

www.rittal.ca



Rittal – The System.

Faster – better – everywhere.



System Accessories

Base/Plinth

Flex-Block Base/Plinth System	424
TS Base/Plinth	426
Base/Plinth	433

Base

Base	435
------------	-----

Walls

Sidewalls	450
Partition Walls	453
Interconnect Kit	458

Baying Systems

Baying	460
--------------	-----

Doors/Locks

Door Models	467
Expansion Accessories for TS Modular Front Design	469
Viewing Windows/Operating Panels	473
Lock Systems	478
Hinges	492
Door, External/Internal	493

Roof/Wall Mounting

Roof	499
Wall Mounting	503

Interior Fittings

Mounting Plates	507
Rail Systems	514
Assembly Components	533
Component Shelves	540
System Lights	545
EMC	551
Interior Fittings for Areas at Risk of Earthquake	554
Grounding	555

Cable Routing

Cable Entry	561
Flange Plates	564
Cable Gland	568
Cable Gland	569
Cable Management	572
Cable Routing 19"	582

19" Installation System

Pivoting Frame	587
Accessories for Data Rack	591
Profile Rails	592
Slide Rails	596
19" Fittings	598
Patch Panels	603
Splicing Boxes	604

Human/Machine Interface

Handles	605
External Mounting Accessories	607
Front Fittings	608
Keyboards, Supports and Drawers	610
Interfaces	617
Signal Pillars	619

Technical Information

RittalXpress	622
CE/Grounding/HD/Model Numbers	623
Protection Categories	624
NEMA	625
Approvals/Equipment Grounding Conductor	627
Coating/Spray Finish	628



Cable entry plates

for

- Cable entry grommets
- Connector grommets

Instead of the standard, segmented divided base plates

Material:

- Carbon steel

Surface finish:

- Zinc-plated

Supply includes:

- Assembly components

For installation in TS, SE and PC enclosures

Enclosure width inches (mm)	Cut-outs per plate	Packs of	Model No.
24 (600)	5	2 pc(s).	8800.060
32 (800)	8	2 pc(s).	8800.080
39 (1000)	4	4 pc(s).	8800.100
47 (1200)	6	4 pc(s).	8800.120

For installation in CM enclosures and TP TopConsole system

Enclosure width inches (mm)	Cut-outs per plate	Packs of	Model No.
24 (600)	5	1 pc(s).	5001.226
32 (800)	8	1 pc(s).	5001.227
39 (1000)	4	1 pc(s).	5001.228
47 (1200)	6	1 pc(s).	5001.229
63 (1600)	8	1 pc(s).	5001.237

For installation in TS, SE and PC enclosures

Enclosure width inches (mm)	Cut-outs per plate	Packs of ¹⁾	Model No.
24 (600)	5	2 pc(s).	4320.700
32 (800)	8	2 pc(s).	4321.700
39 (1000)	10	2 pc(s).	4323.700

¹⁾ Including compensating plate



Accessories:

- Cable entry grommets, see page 562

Three examples from a wide range of options

The graphics show three TS examples for the positioning of cable entry plates instead of segments of the standard three-piece base plates. This enables appropriate positioning in line with the mounting plate.

Thanks to the enclosure symmetry, the cable entry plates, like the base plates, can also be used in the enclosure depth, on the right and left.

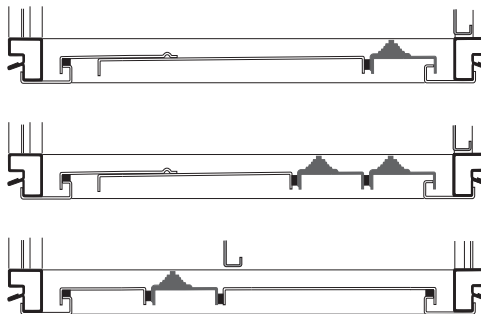
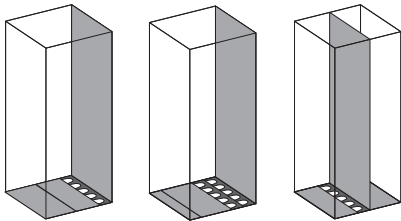

Cable routing

Cable entry

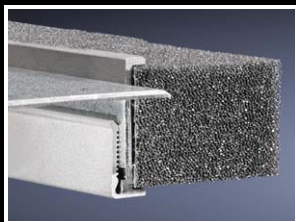
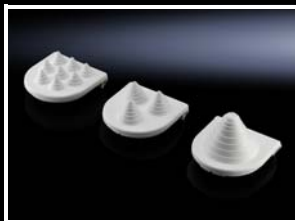

Cable entry grommets

Combined with the cable entry plate for simple and fast sealing of cables inserted in the base area of enclosures.

Material:

- Body: Polypropylene
- Cover: Thermoplastic elastomer

Protection category IP to IEC 60 529:

- IP 55 when installed per instructions

Cable per grommet	Max. Ø mm	Packs of	Model No.
8	13	25 pc(s).	4316.000
3	21	25 pc(s).	4317.000
1	47	25 pc(s).	4318.000

Connector grommets

Suitable for cable diameters from 8 to 36 mm.

Material:

- Outer cover: Polypropylene covered with thermoplastic elastomer
- Seal: Cellular rubber

Protection category IP to IEC 60 529:

- IP 55 when installed per instructions

Packs of	Model No.
10 pc(s).	4311.000

Section for cable entry, center for TS, SE, CM, TP

For top-mounting on base plates. The better alternative to a foam cable clamp strip, thanks to:

- Easier mounting
- Full-surface support
- High level of sealing of cables inserted into the enclosure

Material:

- Extruded aluminum section
- Seal: PU foam
- Cross-section: 30 x 25 mm

Protection category IP to IEC 60 529:

- IP 55 when installed per instructions

Note:

- 1 set is sufficient for one base opening up to an enclosure width of 800 mm, from an enclosure width of 1000 mm upwards, two base openings are present
- Two sets per enclosure may be fitted

For enclosure width inches (mm)	Packs of	Model No.
24 (600)	1 set(s)	8802.060
32 (800)	1 set(s)	8802.080
39 (1000)	2 set(s)	8802.100
47 (1200)	2 set(s)	8802.120
63 (1600)	2 set(s)	8802.160

+ **Accessories:**

- Cable clamping rail (angle profile), see page 574
- C rail 30/15, see page 528

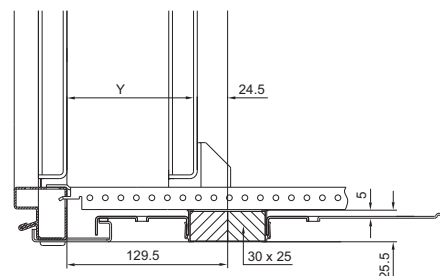

Y = mounting plate is depth-adjustable in the 25 mm hole pattern (last hole pattern 30 mm)

Section for cable entry, rear for TS, SE, CM, TP

Unlike with the section for cable entry, center, the rear section is snap-fastened directly to the base opening. This means that, when installing the mounting plate in the rearmost position (TS), or with CM, the cables may be routed directly to a cable clamping rail without large bending radii. In conjunction with the cable clamping rail, optimum adjustment between the cable entry and mounting plate can be achieved.

Material:

- Extruded aluminum section
- Seal: PU foam
- Cross-section: 30 x 25 mm

Protection category IP to IEC 60 529:

- IP 55 when installed per instructions

Note:

- 1 set is sufficient for one base opening up to an enclosure width of 800 mm, from an enclosure width of 1000 mm upwards, two base openings are present
- 2 sets per enclosure may be fitted

For enclosure width inches (mm)	Packs of	Model No.
24 (600)	1 set(s)	8802.065
32 (800)	1 set(s)	8802.085
39 (1000)	2 set(s)	8802.105
47 (1200)	2 set(s)	8802.125
63 (1600)	2 set(s)	8802.165

+ Accessories:

- Cable clamp rail, see page 574



Self-adhesive foam cable clamp strip

To seal the cable entry between the base plates. Particularly suitable for cables with identical cross-sections.

Material:

- PU foam
- Cross-section: 30 x 30 mm

Protection category IP to IEC 60 529:

- IP 55 when installed per instructions

Packs of	Model No.
118" (3 m)	2573.000

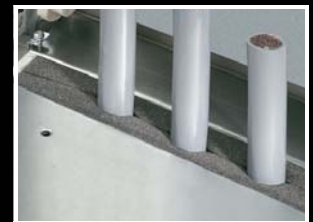

EMC base plates

see page 552

